

Downward View of the Floor Space
SECTION B-B
SCALE 1 : 16

Front of Vehicle

THE KENNEL SHOULD INCLUDE
1 PAIR OF WINDOW GUARDS
AND 1 PAIR OF DOOR COVERS
(FROM #934-0690A)

DRAWN	NAME MQ	DATE 22OCT15		DANDR-ANSI-A REV2 APRIL 1, 2009	SIZE A
CHECKED	AD	22OCT15	Path: Y:\M\MECH_DESIGN\Explorer 2013 K9 Kennel Extend For Two\ File: 934-0727A Date: Friday, October 23, 2015 2:07:10 PM		
THE INFORMATION CONTAINED WITHIN THIS DRAWING IS PROPRIETARY AND CONFIDENTIAL. AND IS THE SOLE PROPERTY OF DandR ELECTRONICS CO. LTD. IT MAY NOT BE REPRODUCED AT WHOLE OR IN PART WITHOUT THE WRITTEN PERMISSION OF DandR ELECTRONICS CO. LTD.			Explorer 2013 Extended K9 For Dual Dogs Kennel		
MFG. NO.		934-0727A		CATALOG. NO.	
USED ON:			SHEET 1 OF 1		
FINISH Midnight Black Wrinkle		MATERIAL 0.125" ALUM		REV. 0	

REV.	DESCRIPTION	BY	DATE	APPROVED

TOP BRKT (2X)
834-2699A



PS&DS DOOR & WINDOW COVERS
SEE DETAIL OF DRAWINGS

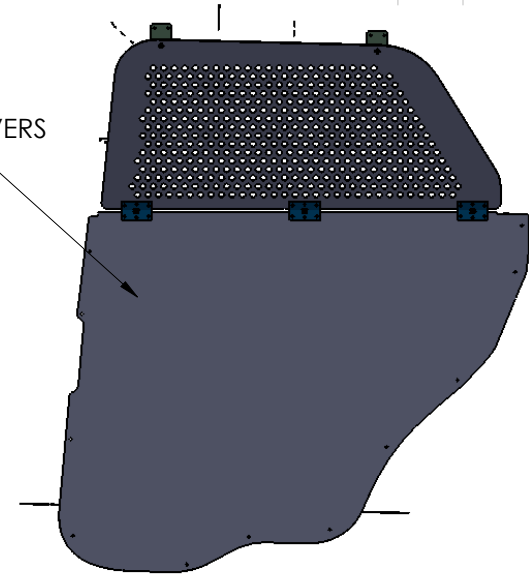

PS&DS FILLERS
834-2702A
834-2701A

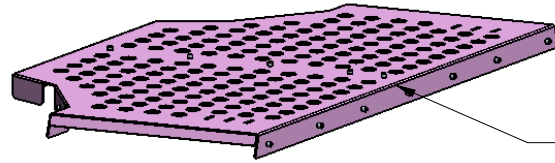

ROOF PANEL

REAR DIVIDER

FRONT DIVIDER

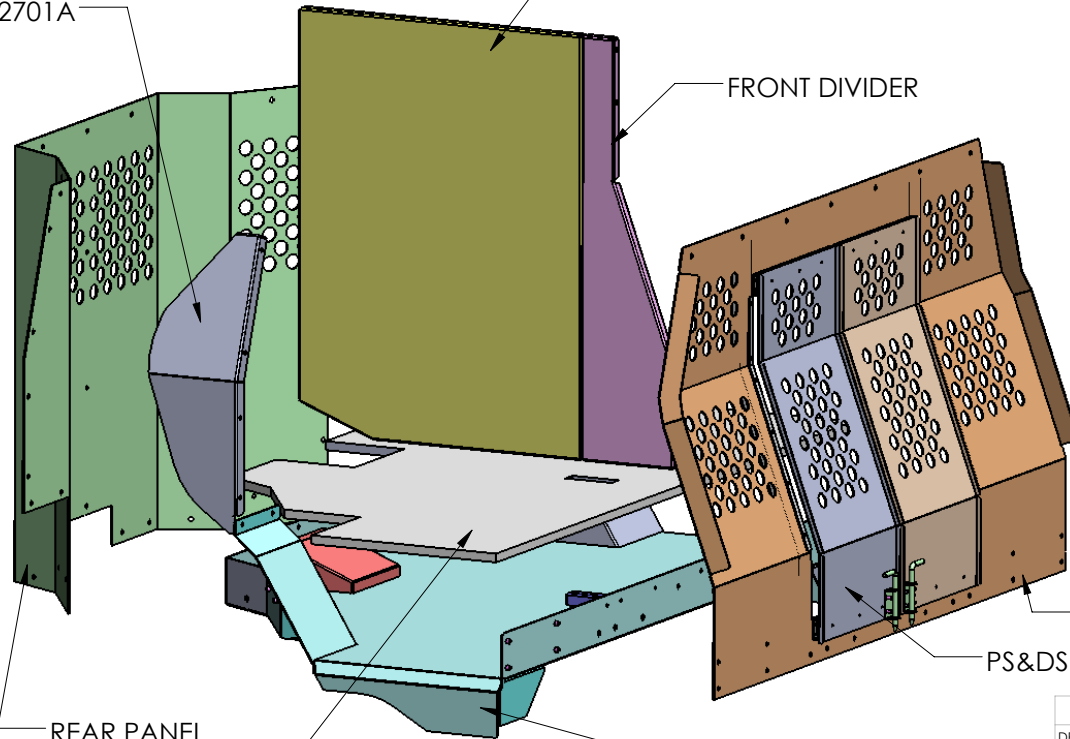

FRONT PANEL

PS&DS SLIDING DOORS

REAR PANEL

RUBBER MAT

BASE

SUBFRAME

THE KENNEL SHOULD INCLUDE
1 PAIR OF WINDOW GUARDS
AND 1 PAIR OF DOOR COVERS.

NAME	DATE	ELECTRONICS CO. LTD. DANDR-ANSI-A REV2 APRIL 1, 2009	SIZE
DRAWN	22OCT15		A
CHECKED	AD	Path: Y:\M\MECH_DESIGN\Explorer 2013 K9 Kennel Extend For Two\ File: 934-0727A Date: Friday, October 23, 2015 2:07:10 PM	
THE INFORMATION CONTAINED WITHIN THIS DRAWING IS PROPRIETARY AND CONFIDENTIAL. AND IS THE SOLE PROPERTY OF DandR ELECTRONICS CO. LTD. IT MAY NOT BE REPRODUCED AT WHOLE OR IN PART WITHOUT THE WRITTEN PERMISSION OF DandR ELECTRONICS CO. LTD.		DESCRIPTION: <h3>Explorer 2013 Extended K9 For Dual Dogs Kennel</h3>	
FINISH		MFG. NO.	CATALOG. NO.
Midnight Black Wrinkle		934-0727A	
MATERIAL		USED ON:	SHEET 1 OF 1
0.125" ALUM			REV. 0